



Use the following measurements to draw the three bear's cottage.

Make sure you use a ruler!



1. Draw a square, each side 14cm long.
Squares have equal sides so make sure they are all the same!



2. Draw a rectangle for the door.
Two long sides, 6cm.
Two short sides, 3cm.

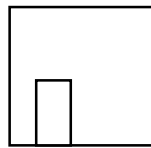

3. Draw three squares for the windows.
Each window should have four equal sides, all 4cm in length.

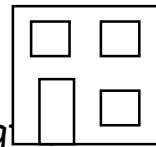

4. Draw a triangle for the roof. Can you measure how long the sides of your roof are?

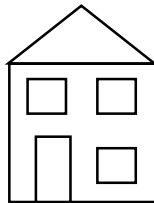

5. Now you have a house, can you decorate it and add some detail?

- Curtains
- Door number
- Chimney
- Garden with trees and flowers